

Roof Design

Roof gardens with Rhenofol CG, loose laid with ballast

Extensive roof garden with Rhenofol CG
Rainwater outlet
Non ventilated roof / Warm roof

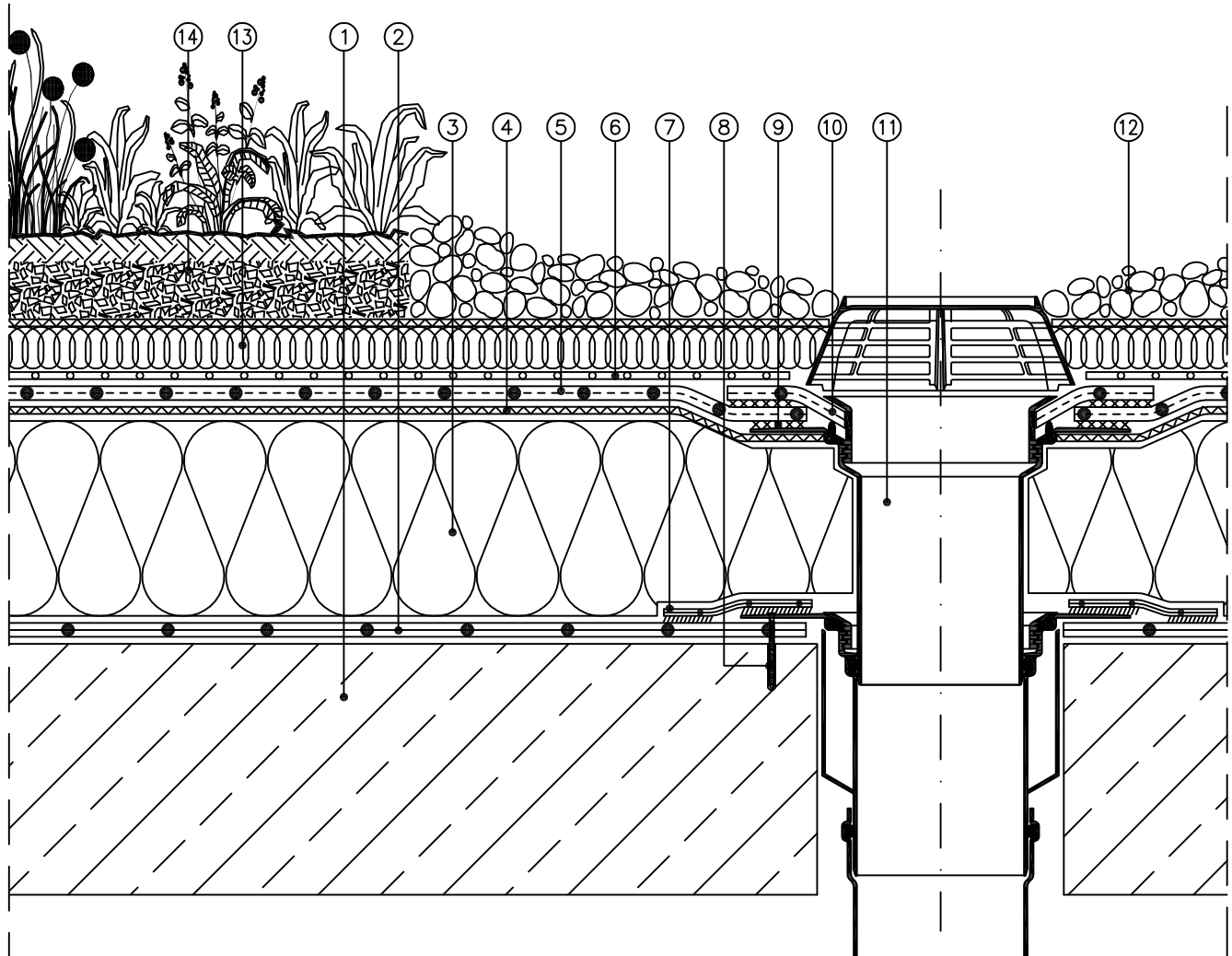

Scale 1:5 (The layers relevant to the sealing are shown accentuated)

- | | |
|---|---|
| ① Reinforced concrete | ⑨ Welding |
| ② FDT vapour control layer PE | ⑩ Rhenofol c collar |
| ③ Thermal insulation to specification | ⑪ FDT vario roof outlet with warm roof attachment |
| ④ Separation layer FDT synthetic fleece 300 g/m ²
(See page 58) | ⑫ Round washed gravel (20mm – 40mm diam.) |
| ⑤ Roofing membrane Rhenofol CG, 1.5 mm thick
(See page 58) | ⑬ Drainage and filter mat |
| ⑥ PE separation layer, 0.2 mm thick | ⑭ Vegetation mat |
| ⑦ FDT connection tape for FDT vapour control layer PE | |
| ⑧ Rainwater outlet fixings | |