

Roof Design

Rhenofol CG loose laid with ballast

Roof light connection
 Non ventilated roof / Warm roof

Note:

The upstands must be approved by the roof light manufacturer for this application, otherwise a separate perimeter fixing is required.

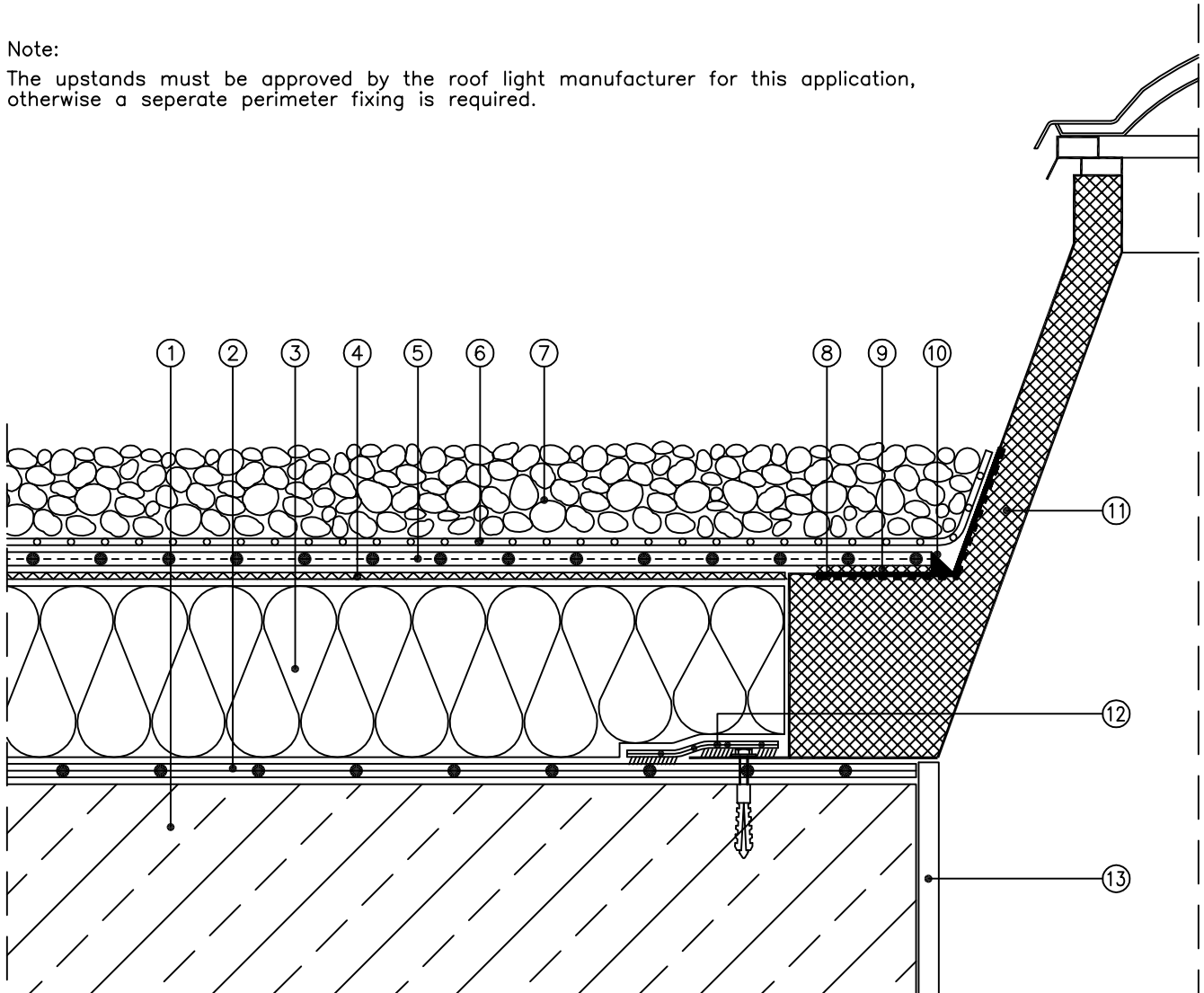

Scale 1:5 (The layers relevant to the sealing are shown accentuated)

- | | |
|--|---|
| ① Reinforced concrete | ⑧ Integrated rigid PVC strip |
| ② FDT vapour control layer PE | ⑨ Welding |
| ③ Thermal insulation to specification | ⑩ Rhenofol paste |
| ④ Separation layer FDT glass flece 120 g/m ²
(See page 36) | ⑪ Insulated roof light kerb |
| ⑤ Roofing membrane Rhenofol CG | ⑫ FDT connection tape for vapour control layer PE |
| ⑥ PE separation layer, 0.2 mm thick
(See page 37) | ⑬ Plaster |
| ⑦ Min. 50 mm round washed gravel
(20mm – 40mm diam.) | |