

Roof Design

Roof gardens

with Rhenofol CG loose laid with ballast

Intensive roof garden with Rhenofol CG
 Wall connection
 Non ventilated roof / warm roof

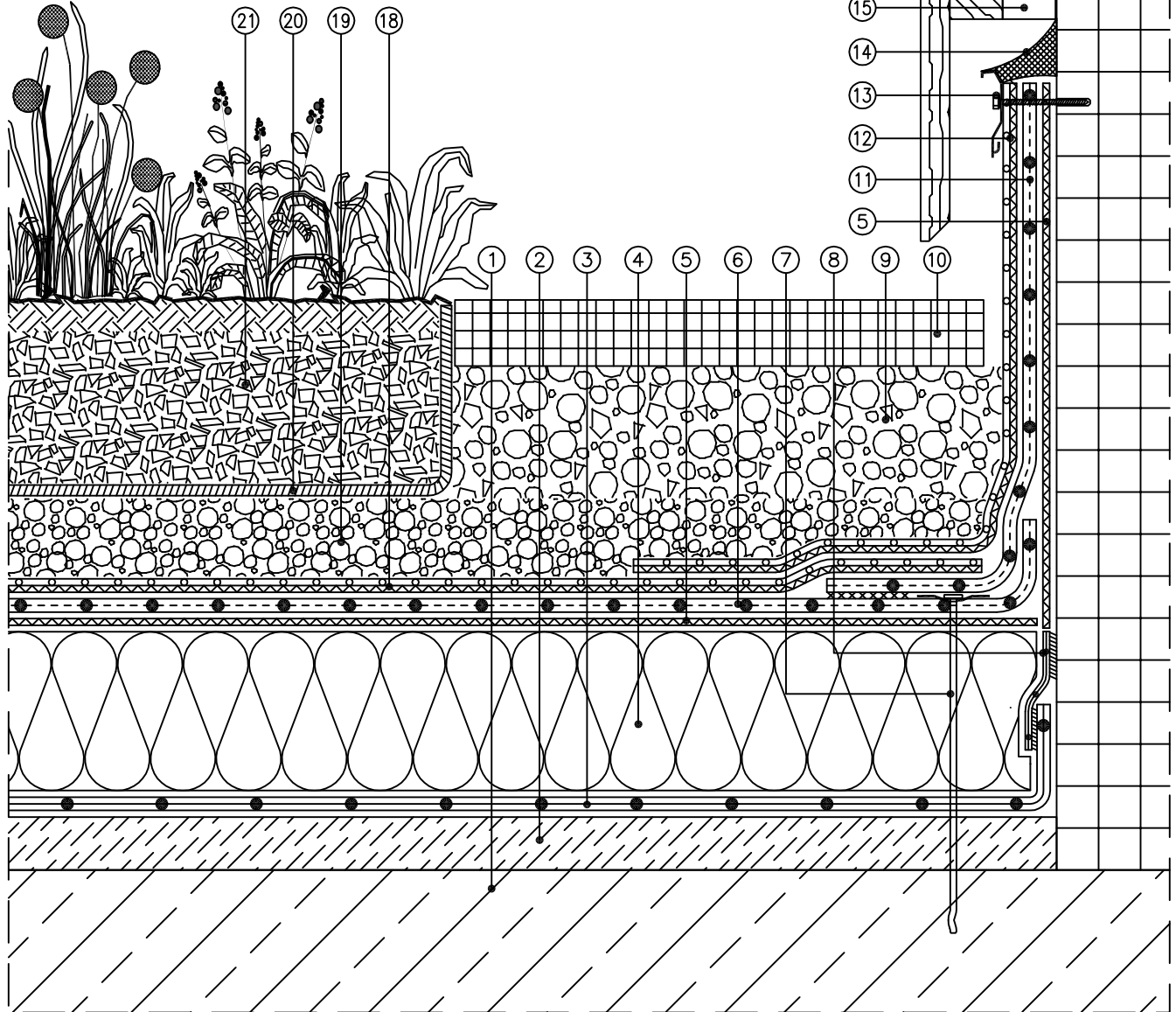

Scale 1:5 (The layers relevant to the sealing are shown accentuated)

- | | |
|---|---|
| ① Reinforced concrete | ⑪ Rhenofol cg flashing strip |
| ② Screed to falls | ⑫ FDT protection layer |
| ③ FDT vapour control layer PE | ⑬ FDT aluminium wall connection profile Classic |
| ④ Thermal insulation to specification | ⑭ FDT sealant A |
| ⑤ Separation layer FDT synthetic fleece 300 g/m ²
(See page 58) | ⑮ Timber battern |
| ⑥ Roofing membrane Rhenofol CG, 1.5 mm thick
(See page 58) | ⑯ Counter battern |
| ⑦ Perimeter fixing | ⑰ Cladding |
| ⑧ FDT connection tape for vapour control layer PE | ⑱ FDT protection layer |
| ⑨ Gravel bed | ⑲ Drainage layer |
| ⑩ Paving slabs | ⑳ Filter layer |
| | ㉑ Vegetation layer |